

the modular inserts must be installed in suitable frames which are then mounted in traditional housings \* or COB panel support

frames for modular units \* ..... page: 151\*\*

\* enclosures: housings or high construction hoods

- characteristics according to EN 61984:

**200A 1000V 8kV 3**

- certifications: (cULus), (E), (CCC); the certifications shown in brackets are being applied for  
 - for maximum current load, see the insert load curve MIXO series (CX 01 Y)

\*\* refer to catalogue page CN.07

modular units,  
crimp connections

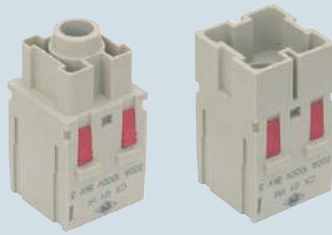

**NEW**

200A silver plated crimp contacts  
heat shrink tube



description	part No.	part No.
without contacts (to be ordered separately) - female inserts for female contacts - male inserts for female contacts	<b>CX 01 YF</b> <b>CX 01 YM</b>	
<b>200A female crimp contacts</b> 16 mm <sup>2</sup> AWG 6 one groove (back side) 25 mm <sup>2</sup> AWG 4 with no grooves 35 mm <sup>2</sup> AWG 2 one groove 50 mm <sup>2</sup> AWG 1 two grooves 70 mm <sup>2</sup> AWG 2/0 with no grooves  <b>200A male crimp contacts</b> 16 mm <sup>2</sup> AWG 6 one groove (back side) 25 mm <sup>2</sup> AWG 4 with no grooves 35 mm <sup>2</sup> AWG 2 one groove 50 mm <sup>2</sup> AWG 1 two grooves 70 mm <sup>2</sup> AWG 2/0 with no grooves		<b>CYFA 16</b> <b>CYFA 25</b> <b>CYFA 35</b> <b>CYFA 50</b> <b>CYFA 70</b>  <b>CYMA 16</b> <b>CYMA 25</b> <b>CYMA 35</b> <b>CYMA 50</b> <b>CYMA 70</b> silver plated
heat shrink tube for CYFA/CYMA 16 contacts or for conductor with total external Ø < 10 mm		<b>CR TT</b>

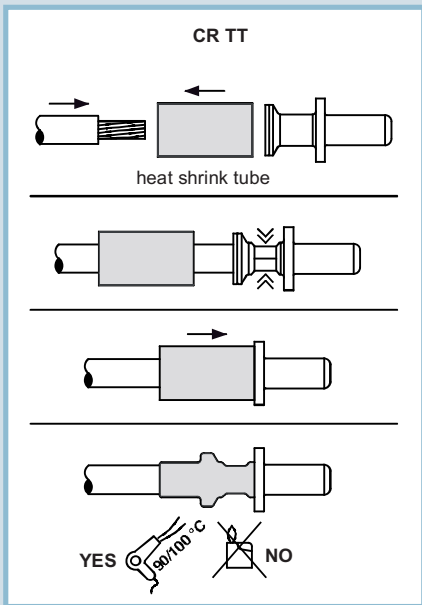

dimensions in mm

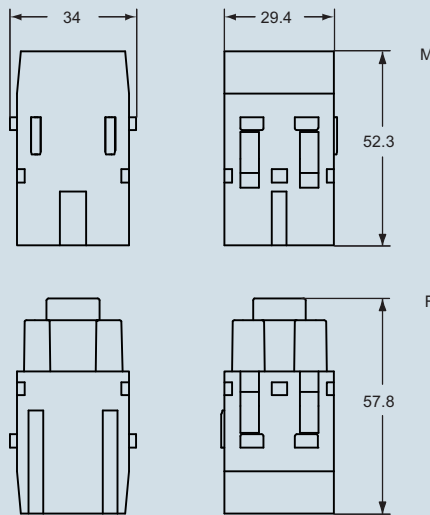

contacts side (front view)

side with reference arrow ▲

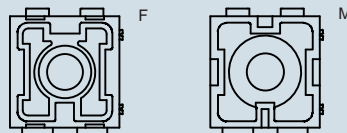

- 2 frame slots

dimensions in mm

**CYF and CYM**

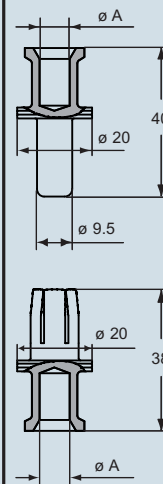

**CYF and CYM contacts**

conductor section (mm <sup>2</sup> )	ø slot A (mm)	conductor stripping length (mm)
16	6.1	15
25	7.0	15
35	8.2	15
50	9.8	15
70	11.8	15

dimensions shown are not binding and may be changed without notice

the modular inserts must be installed in suitable frames which are then mounted in traditional housings or COB panel support

frames for modular units ..... page: 151\*

- characteristics according to EN 61984:

**3 poles 40A 830V 8kV 3**

**4 poles 10A 830V 8kV 3**

- certifications: (c) (us), (s), (cc), (u); the certifications shown in brackets are being applied for

- for maximum current load, see the insert load curve MIXO series page 6

- for contact crimping, see the crimp tool section (40A contacts CXF, CXM series and 10A contacts CDF, CDM series) on pages 296, 298, 300, 304, 306, 308 \*

- male and female contacts to test of contact with fingers

- maximum Ø of the insulator, contacts of power: 5 mm

\* refer to catalogue page CN.07

modular units,  
crimp connections



**AVAILABLE  
2<sup>nd</sup> QUARTER 2010**

40A and 10A crimp contacts  
silver and gold plated



description	part No.	part No.	part No.
without contacts (to be ordered separately) - female inserts for female contacts - male inserts for male contacts	<b>CX 3/4 XDF</b> <b>CX 3/4 XDM</b>		
<b>40A female crimp contacts</b> 1.5 mm <sup>2</sup> AWG 16 2.5 mm <sup>2</sup> AWG 14 4 mm <sup>2</sup> AWG 12 6 mm <sup>2</sup> AWG 10		<b>CXFA 1.5</b> <b>CXFA 2.5</b> <b>CXFA 4.0</b> <b>CXFA 6.0</b>	<b>silver plated</b>
<b>40A male crimp contacts</b> 1.5 mm <sup>2</sup> AWG 16 2.5 mm <sup>2</sup> AWG 14 4 mm <sup>2</sup> AWG 12 6 mm <sup>2</sup> AWG 10		<b>CXMA 1.5</b> <b>CXMA 2.5</b> <b>CXMA 4.0</b> <b>CXMA 6.0</b>	<b>silver plated</b>
<b>10A female contacts</b> 0.14-0.37 mm <sup>2</sup> AWG 26-22 identification No. 1 0.5 mm <sup>2</sup> AWG 20 identification No. 2 0.75 mm <sup>2</sup> AWG 18 identification No. ② 1 mm <sup>2</sup> AWG 18 identification No. 3 1.5 mm <sup>2</sup> AWG 16 identification No. 4 2.5 mm <sup>2</sup> AWG 14 identification No. 5		<b>CDFA 0.3</b> <b>CDFA 0.5</b> <b>CDFA 0.7</b> <b>CDFA 1.0</b> <b>CDFA 1.5</b> <b>CDFA 2.5</b>	<b>silver plated</b>
<b>10A male contacts</b> 0.14-0.37 mm <sup>2</sup> AWG 26-22 identification No. 1 0.5 mm <sup>2</sup> AWG 20 identification No. 2 0.75 mm <sup>2</sup> AWG 18 identification No. ② 1 mm <sup>2</sup> AWG 18 identification No. 3 1.5 mm <sup>2</sup> AWG 16 identification No. 4 2.5 mm <sup>2</sup> AWG 14 identification No. 5		<b>CDMA 0.3</b> <b>CDMA 0.5</b> <b>CDMA 0.7</b> <b>CDMA 1.0</b> <b>CDMA 1.5</b> <b>CDMA 2.5</b>	<b>gold plated</b>
		<b>CDFD 0.3</b> <b>CDFD 0.5</b> <b>CDFD 0.7</b> <b>CDFD 1.0</b> <b>CDFD 1.5</b> <b>CDFD 2.5</b>	<b>gold plated</b>

CXF and CXM contacts		
conductor section mm <sup>2</sup>	conductor slot ø A (mm)	B (mm)
1.5	1.8	9
2.5	2.2	9
4	2.85	9.6
6	3.5	9.6

CDF and CDM contacts		
conductor section mm <sup>2</sup>	conductor slot ø A (mm)	B (mm)
0.14+0.37	0.9	8
0.5	1.1	8
0.75	1.3	8
1.0	1.45	8
1.5	1.8	8
2.5	2.2	6

- stripping length see section feature of inserts on page 13 catalogue CN.07

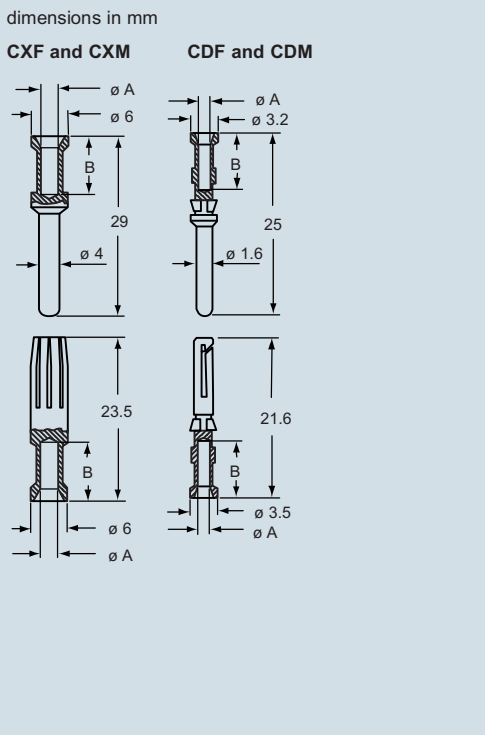
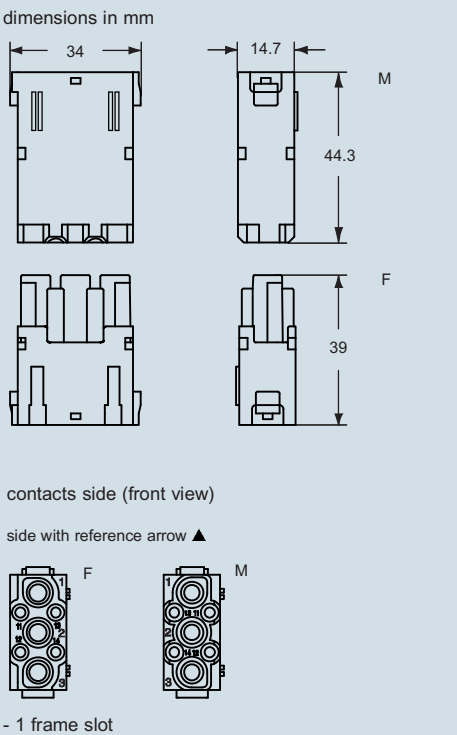

dimensions shown are not binding and may be changed without notice