

Use

The CT-series multipole connectors (with incorporated terminal block) are recommended for greater cost-saving and safety for use on machines and command and control panels.

For control panel mounting, bulkhead housings must be used. This makes it possible to maintain the IP65 degree of protection (in accordance with EN 60529) for coupled housing-mounted connectors.

The CT series inserts (10A max versions) are supplied in the plug or socket versions and must be mounted with insertion from the rear of the enclosure (Figures 1 and 2). The space occupied by the terminal block does not allow for the passage of the insert and insertion from the front of the enclosure.

As an alternative to the traditional terminal blocks, the inserts can be mounted inside the control panels on DIN EN rails (Figure 5) using suitable accessories providing the added advantage of easy sectioning.

The special structure of the CT inserts has all the conductor connections on the same side providing for easier wiring and a complete view of the work area.

The terminal block also has slots for housing the identification wire markers of each contact. Wire markers of different manufacturers may be used such as: Cabur, Grafoplast, Modernotecnica, Phoenix, Siemens, Wago, Weidmüller.

The CT series is available in the versions "left" and "right" for mounting on the left (Figure 3) or on the right (Figure 4) of the control panel walls.

This characteristic is determined by the position of contact "1" and the ground terminal in the upper part of the insert terminal block for both left and right mounting.

The installation of inserts on DIN rails (Figure 5) inside the control panels is usually made to facilitate the wiring in sectionable parts.

In this case the degree of protection for coupled connectors is IP20 (in accordance with EN 60529).

This type of mounting requires supports (CT APE) to be provided to the inserts suitable for mounting on DIN EN 60715 rail.

In addition, CRBF (female) and CRBM (male) coupling screws instead of normal screws are recommended for fixing the inserts to the enclosures (Figure 5) in order to guarantee a stable and safe coupling between the CT and CTS inserts installed on the DIN rails and corresponding CD inserts.

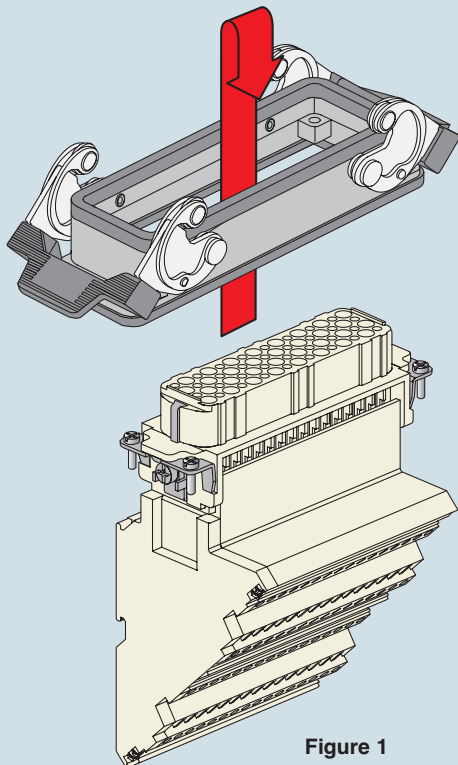

Figure 1

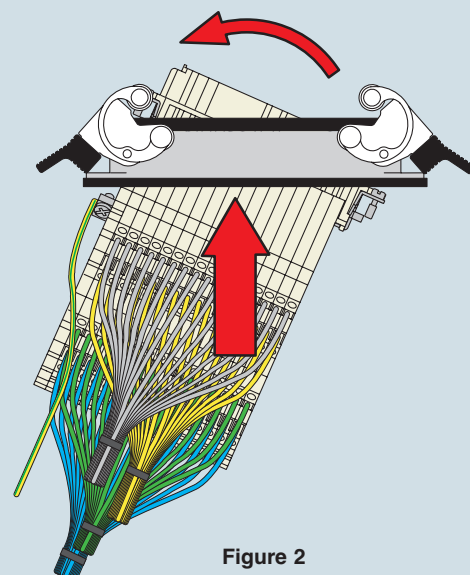

Figure 2

Figures 1 and 2 (rear mounting)

The insert is inserted into the bulkhead housing with pre-wired conductors connected at the opposite end.

Figure 3 (left mounting)

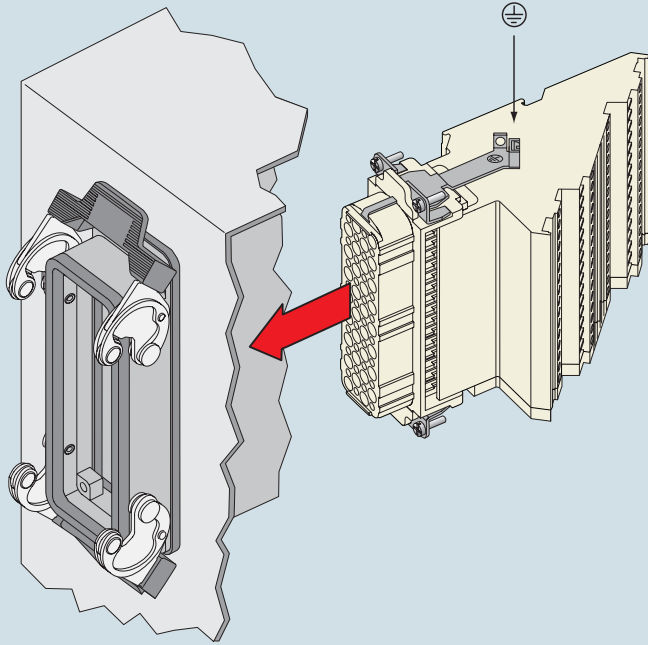
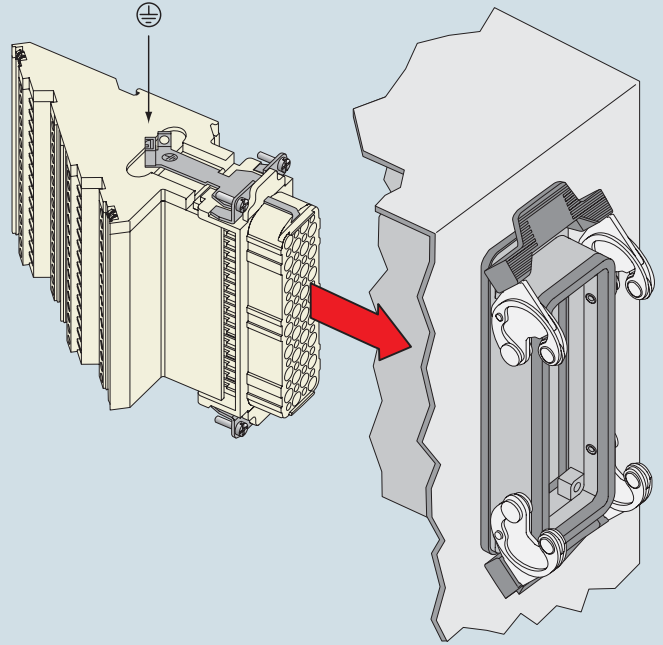
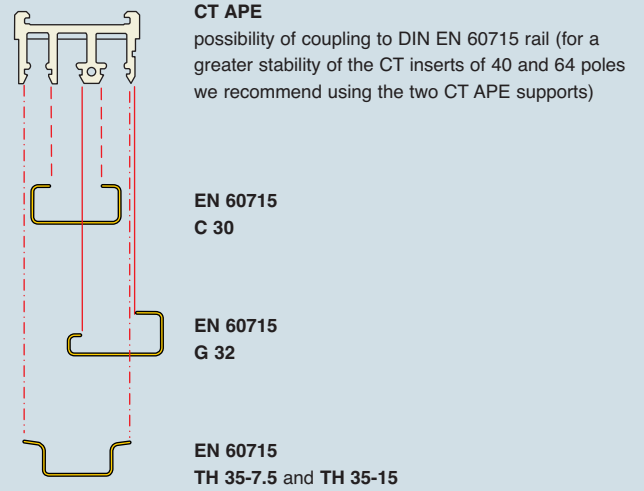
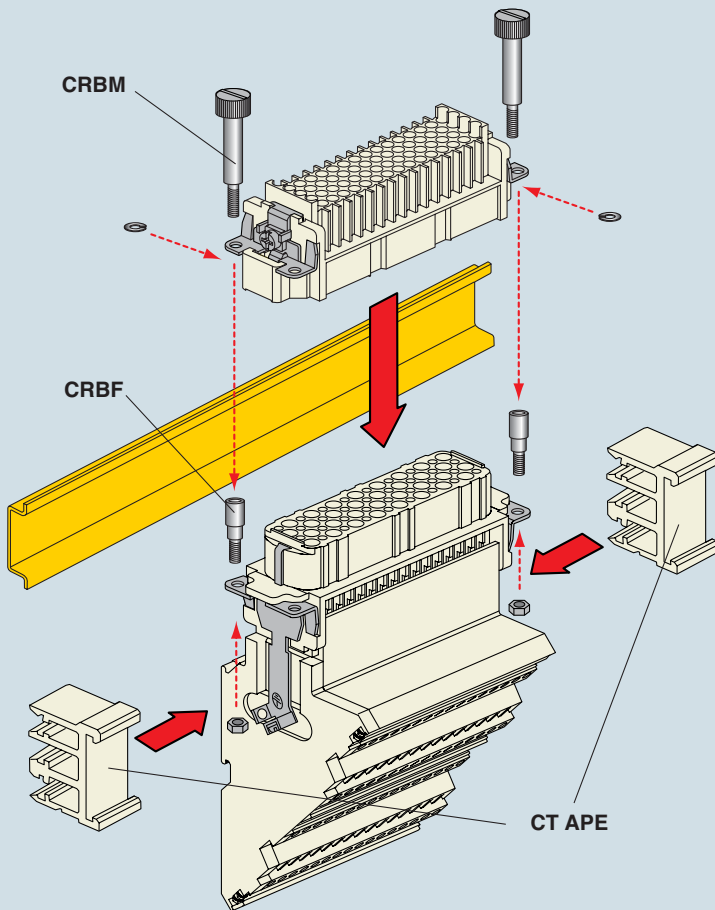

Figure 4 (right mounting)



CT - CTS

Figure 5 (mounting on DIN rail)



accessories for CT inserts

- support for mounting on DIN rail (**CT APE** page 263)
- inserts coupling screws (**CRBM** and **CRBF** page 263)
- cable-clamping plates (**CRAD** and **CRAS** page 263)

enclosures¹⁾:

size "77.27"

standard page: 198
aggressive environments page: 209
EMC page: 210

¹⁾ only bulkhead mounted housings

- features according to EN 61984:
10A 250V 4kV 3
- UL, CSA, CCC, GL certified
- can be mated with CD inserts
- rear-mounted inserts
- for maximum current load, see the insert load curve section on page 29

**terminal block inserts
screw terminal connection**



**terminal block inserts
spring terminal connection**



description	part No.	part No.	part No.	part No.
side-mounting female inserts with female contacts 1) male inserts with male contacts 1)	left CTF 40 L CTM 40 L	right CTF 40 R CTM 40 R		
side-mounting female inserts with female contacts male inserts with male contacts			left CTSF 40 L CTSM 40 L	right CTSF 40 R CTSM 40 R

1) for non-prepared conductors

connection with spring terminal

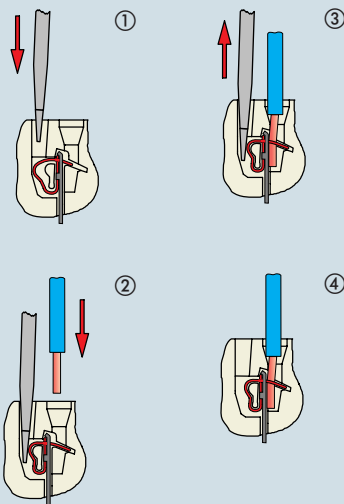

dimensions in mm

female inserts (CTF and CTSF)

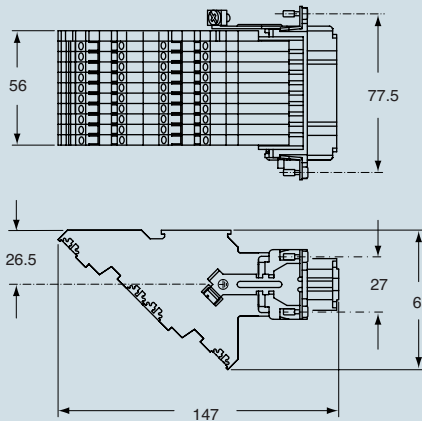

male inserts (CTM and CTSM)

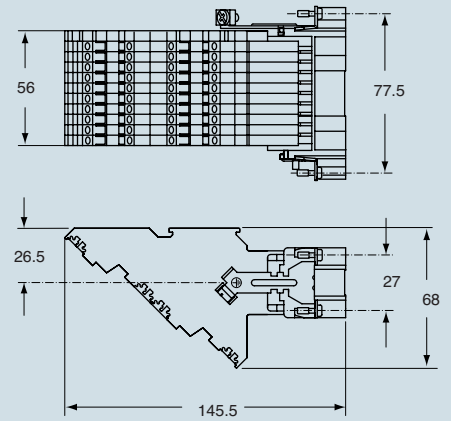

contacts side (front view)

female inserts (CTF and CTSF)

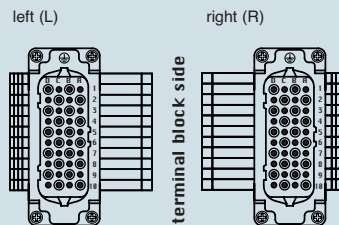

male inserts (CTM and CTSM)

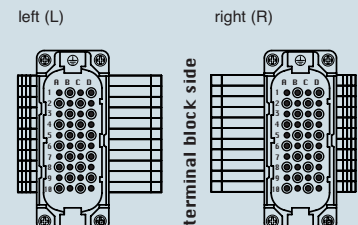

- CT inserts with plate, for section conductors:
0.75 ÷ 2.5 mm² - AWG 18 ÷ 14
- torsion couple recommended for conductor fastening screws and stripping length see section feature of inserts on page 13

- CTS spring inserts for section conductors:
effective sections for non-prepared conductors
0.14 ÷ 2.5 mm² - AWG 26 ÷ 14
effective sections for prepared conductors
0.14 ÷ 1 mm² - AWG 26 ÷ 18
- stripping length see section feature of inserts on page 13

dimensions indicated are not binding and may be changed without notice

CT - CTS

enclosures¹⁾:

size "104.27"

standard	page:	212
aggressive environments	page:	223
EMC	page:	224

¹⁾ only bulkhead mounted housings

- features according to EN 61984:
- 10A 250V 4kV 3**
- UL, CSA, CCC, GL certified
- can be mated with CD inserts
- rear-mounted inserts
- for maximum current load, see the insert load curve section on page 29

**terminal block inserts
screw terminal connection**

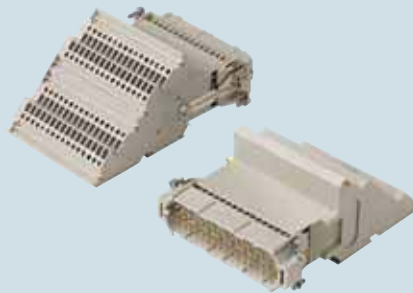

**terminal block inserts
spring terminal connection**



description	part No.	part No.	part No.	part No.
side-mounting female inserts with female contacts 1) male inserts with male contacts 1)	left CTF 64 L CTM 64 L	right CTF 64 R CTM 64 R	left CTS F 64 L CTSM 64 L	right CTS F 64 R CTSM 64 R
side-mounting female inserts with female contacts male inserts with male contacts				

1) for non-prepared conductors

connection with spring terminal

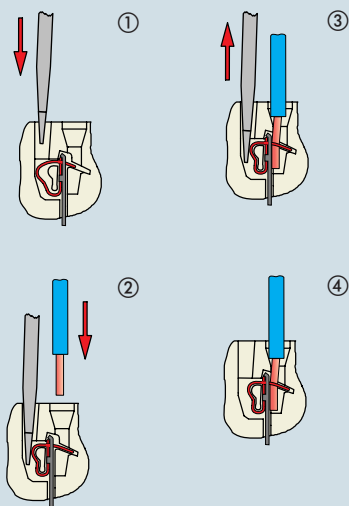

dimensions in mm

female inserts (CTF and CTSF)

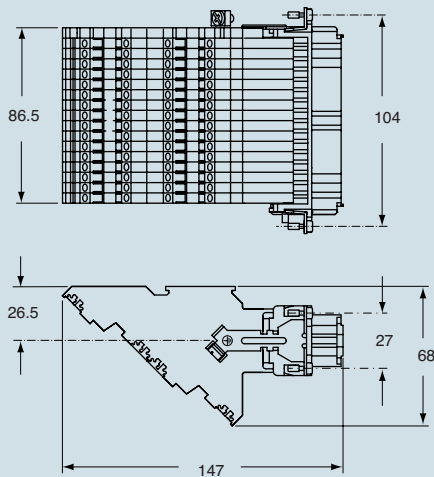

male inserts (CTM and CTSM)

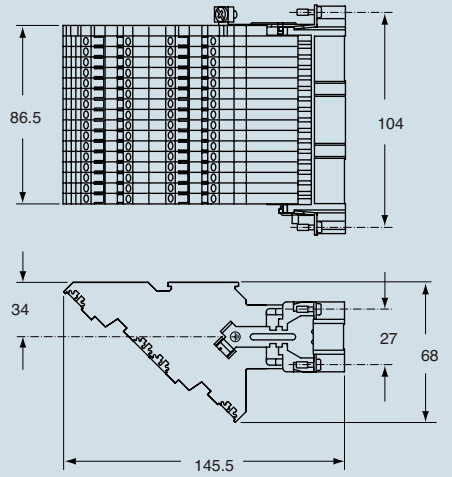

contacts side (front view)

female inserts (CTF and CTSF)

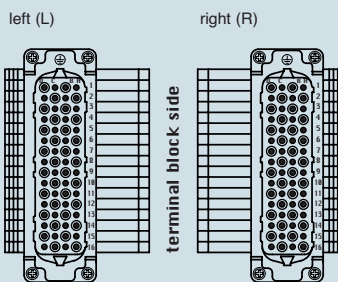

male inserts (CTM and CTSM)

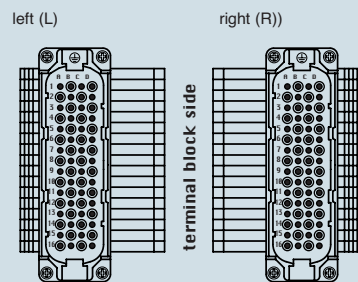

- CT inserts with plate, for section conductors:
0.75 ÷ 2.5 mm² - AWG 18 ÷ 14
- torsion couple recommended for conductor fastening screws and stripping length see section feature of inserts on page 13

- CTS spring inserts for section conductors:
effective sections for non-prepared conductors
0.14 ÷ 2.5 mm² - AWG 26 ÷ 14
effective sections for prepared conductors
0.14 ÷ 1 mm² - AWG 26 ÷ 18
- stripping length see section feature of inserts on page 13

dimensions indicated are not binding and may be changed without notice